

Audio Solutions



What is Audio Solutions?

Audio Solutions is a cabling system that enables the user to distribute their favourite music to every room in the home with the flexibility of adding more music sources to every location.

It's simple, affordable and easy to install, but best of all it's easy to use.

Typical Applications

Outdoor Entertaining

Outdoor entertaining is one of Australia's favourite pastimes. Whether you are having a BBQ, party, sitting by the pool, drinks with friends or just pottering around in the garden - you can listen to your favourite tunes or the radio.



Kitchen / Dining Room

Preparing the evening meal or having a dinner party will have more atmosphere with your favourite music playing in the background.



Bedrooms

Everyone needs some time to themselves and in a busy family the bedroom is usually the only option. Whether you are young or old you can relax and listen to your own music your way.

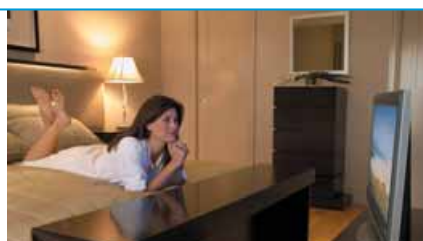

Rumpus Room / Games Room

Having friends around for some fun and games can be made even better with some music playing in the background.



Garage / Home Gym

Get your workout up and running with your favourite motivational music pumping while you get fit or just have some music playing in the background while you work in the garage.



Audio Distribution

The flexibility of being able to listen to the radio, CD's, music DVD's, MP3 players or any music source is made easy with Clipsal Audio Solutions.

The Clipsal Audio Solutions Range can distribute any music source that has audio RCA output ports or 3.5mm Mini Jack ports.

RCA left and right Audio



3.5mm Stereo Mini Jack



Making the most of the Latest Trends

The latest music trend is MP3 format music. MP3 players and downloadable music from the Internet is a fast growing business. Many people are now storing their music on computers and downloading the music to MP3 players such as iPod's.

Computers may be the preferred way to store music files but there is still a need to be able listen to music from multiple locations throughout the home without having to listen to it from monitor speakers.

The Clipsal Audio Solutions product range is a fantastic way of being able to listen to the music from the main music source or have the flexibility to be able to add your own music source in each zone while others can listen to the main source or their local music source.



3105SIMPS Stereo Input Module wih Power Supply



Emitter Lead
8050/21D

The Stereo Input Module Wall Plate connects your music source to the Clipsal Audio Solutions Cabling System located at the main music source.

The Stereo Input Module comes complete with a power supply that enables up to 4 music zones to be connected. More music zones can be added to the system by using the Audio Distribution Junction Box.

The Stereo Input Module also has an IR remote control facility built into it to enable the remote control of the source. (If the source can be remotely controlled ex DVD player).

Note: The IR emitter lead is sold separately.

Simply connect your music source to the stereo input plate by either a 3.5mm Stereo Mini Jack to an RCA lead or by RCA to RCA lead depending on the source output.

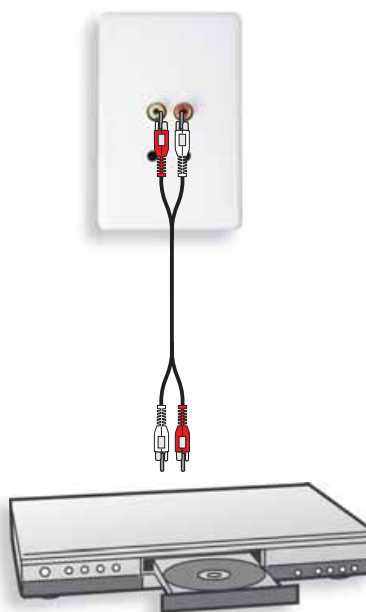

3105LSIM Local Stereo Input Module



The Local Stereo Input Module allows the connection of a local music source to the system. Simply plug the 3.5mm Stereo Mini Jack into the Local Stereo Input Wall Plate and the main source is disconnected and the local source takes over for that zone only.

Disconnect the 3.5mm Stereo Mini Jack from the Local Stereo Input Wall Plate and it reverts back to the main source.

It's simple and easy to use.

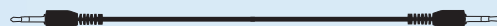

The 3105LSIM comes complete with a 3.5mm to 3.5mm Stereo Mini Jack.

A typical scenario for the Local Input Wall Plate is when family members want to listen to different music in different rooms. Simply take your MP3 player or other music source and connect it to the Local Input Wall Plate.

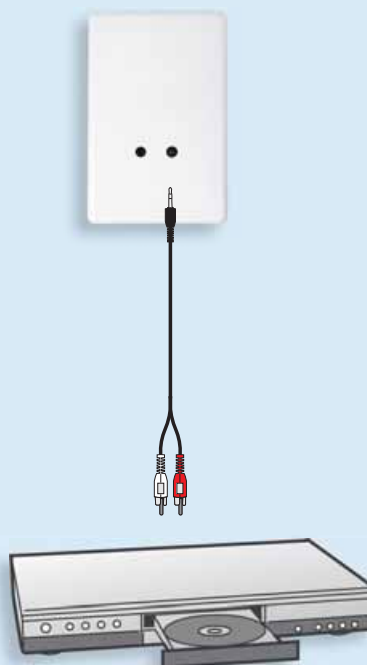

3105VCRC,WE Volume Control with Remote Control

The volume control is an 8-watt amplifier that controls music for that zone.

Functions include ON, OFF and Volume Up and Volume Down. The same functions can be controlled via the remote control that is provided with each Volume Control Wall Plate.

One Remote Control can control the entire stereo input module.

Each volume control is connected to a pair of speakers for left and right stereo sound. Only one pair of speakers can be connected to each volume control. A Volume Control and pair of speakers are called a zone. One remote can control all of the Input Module



Remote Control of the Source

With the Clipsal Audio System you can remotely control the source as the IR facility has an IR facility built in. The addition of an IR emitter lead (sold separately) can be added to the Audio Solution System at any stage after the installation has been completed. Refer to the diagram below.

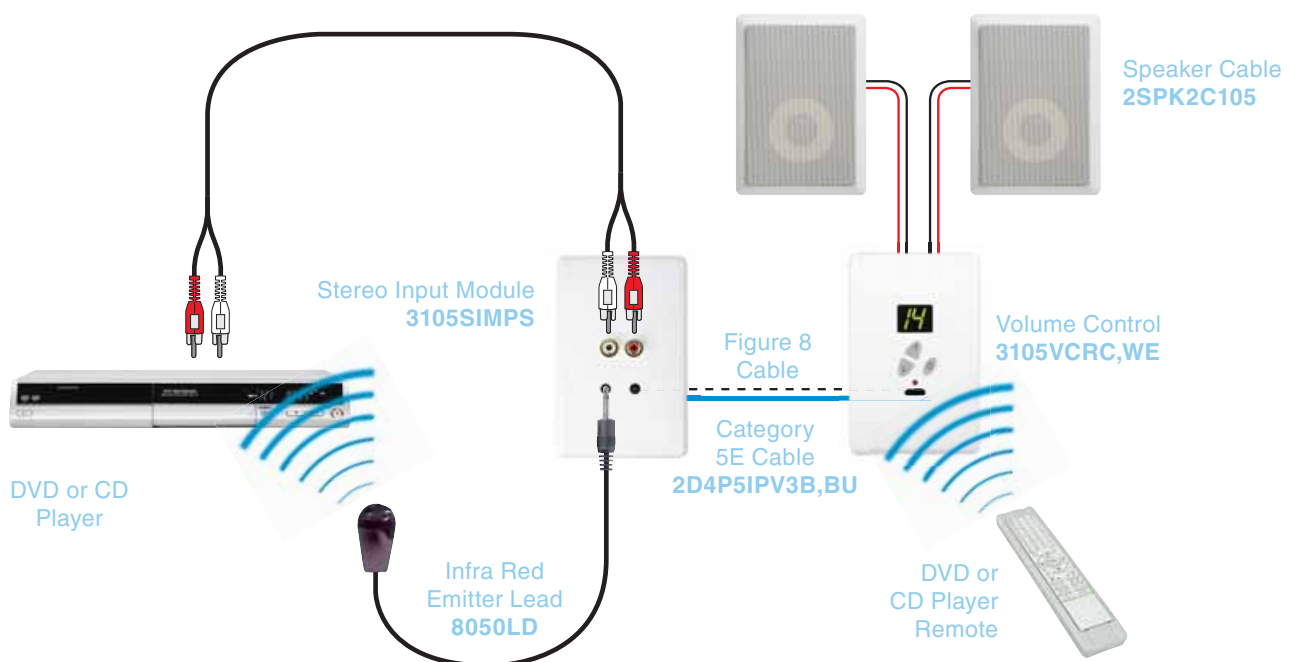

3105ADJB Audio Distribution Junction Box



The Audio Distribution Junction Box is used when more than four zones are required.

Up to seven zones can be connected to the 3105ADJB. The 3105ADJB can be connected to another 3105ADJB to expand the system where more than seven zones are required.

Two power supplies are required for systems with more than four zones. The first power supply comes with the Stereo Input Module and a second power supply can be purchased separately (3105APS24V).

3105ADJB Audio Distribution Power Supply



The Audio Power Supply is a 24V DC power supply. (3105APS24V)



Power Supply from the 3105SIMPS

Audio Distribution Junction Box



2nd Power Supply (sold separately)





Speaker Options, Tools and Cabling

In-Ceiling Speakers



5600ICK,WE (Kevlar Drivers)
5600ICP,WE (Polypropylene Drivers)

In-Wall Speakers



5600IWK,WE (Kevlar Drivers)
5600IWP,WE (Polypropylene Drivers)

Outdoor Speakers



5600ODP,WE
5600ODP,BK

Tool Kit

Cable
Cutters



852QCPH

Screw Driver
Flat Head 2.4mm



2.4mm

Punch
Down
Tool



3100RJA5V

Cabling

Fig 8 Cable



**14/020 AWG18 or
24/020 AWG20**

Category 5 Cable

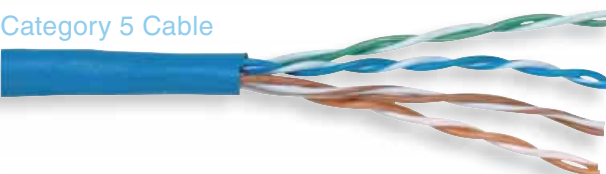

2D4P5IPV3B,BU

Speaker Cable



**2SPK2C105 (1.5mm²)
2SPK2C259 (3.0mm²)**

Four Zones 'Star Wired'

Four Zones can be 'star wired' to receive the main music source.

Each zone can be operated independently for ON, OFF and volume settings.

Four Zones can only listen to the main music source.

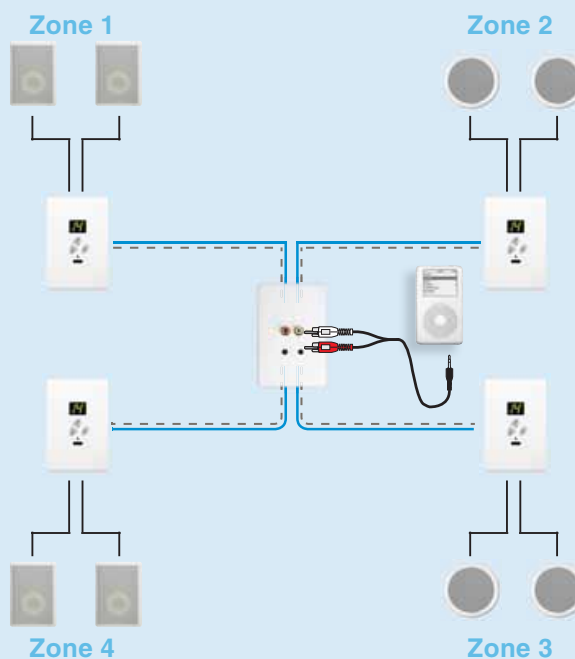

4 Zones 'Star Wired' with Local Inputs

Up to four Zones can be 'star wired' with a Local Stereo Input Module at each zone.

Each zone can be operated independently for ON, OFF and volume settings.

Four Zones can listen to the main music source or can listen to the local music source.

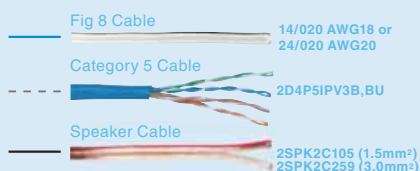
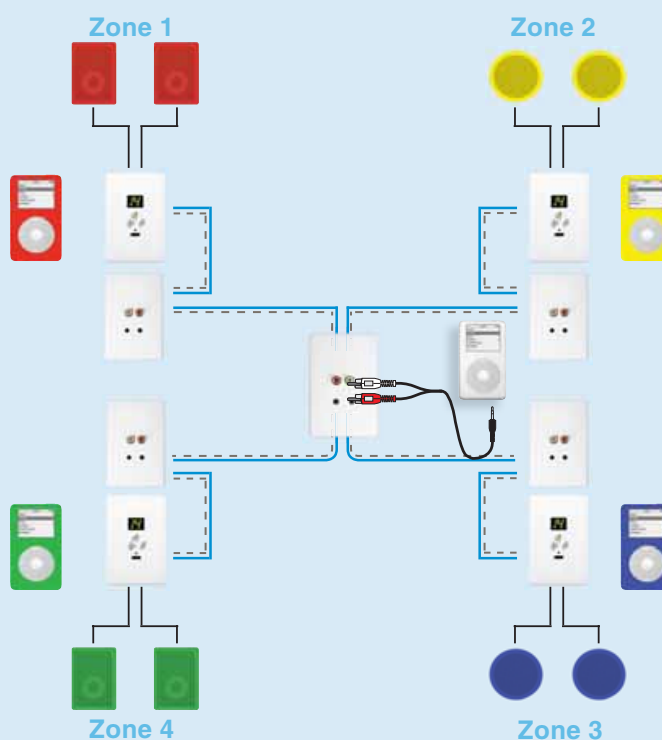

Four Zones 'Loop Wired'

Four zones can be 'loop wired' to receive the main music source.

Each zone can be operated independently for ON, OFF and volume settings.

Four Zones can only listen to the main music source.

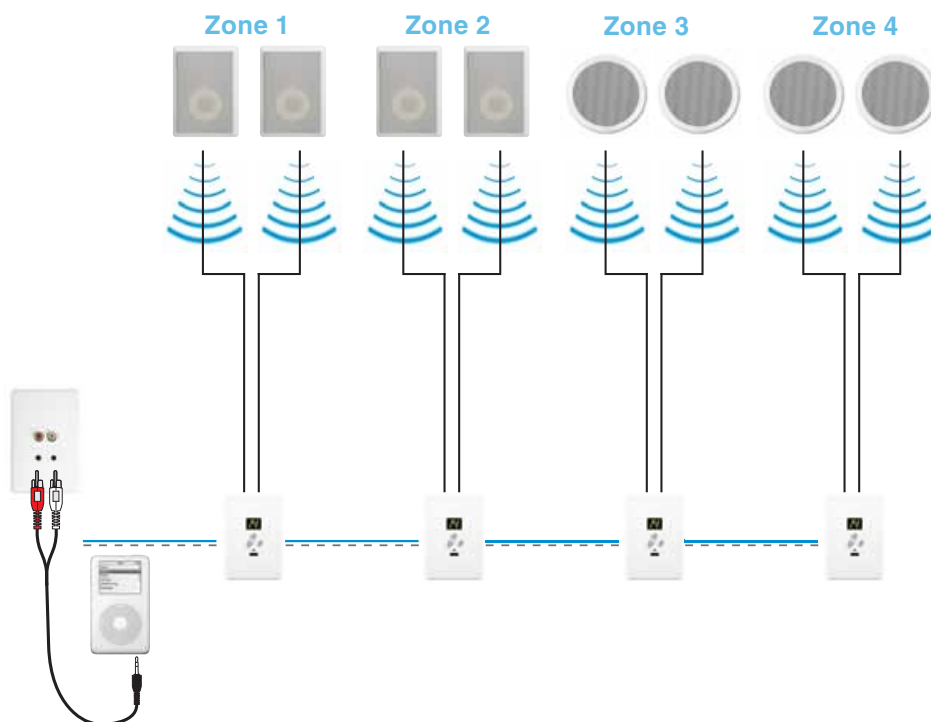

Four Zones 'Loop Wired' with Local Inputs

Up to four zones can be 'loop wired' with a Local Stereo Input Module at each zone.

Each zone can be operated ON, OFF and volume settings.

Four zones can listen to the main music source or can listen to the local music source.

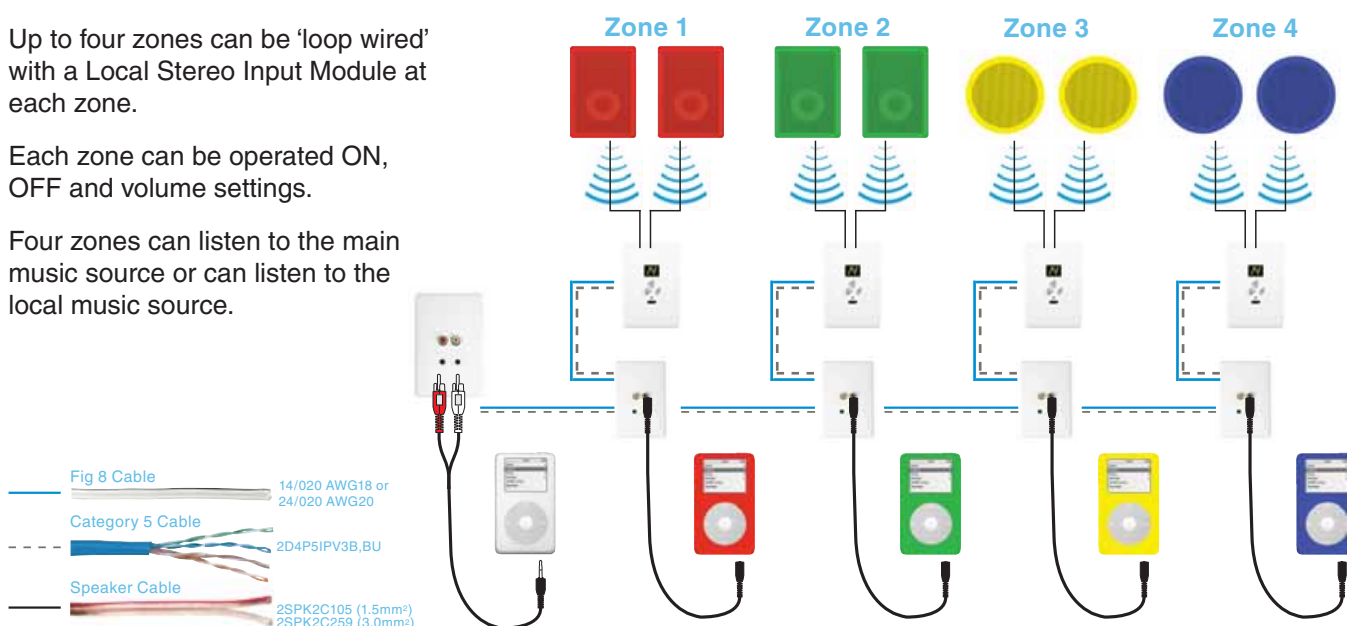

Seven Zones 'Star Wired' with 3105ADJB

Seven zones can be 'star wired' to receive the main music source from the Audio Distribution Junction Box.

Each zone can be operated independently for ON, OFF and volume settings.

Four zones can only listen to the main music source.

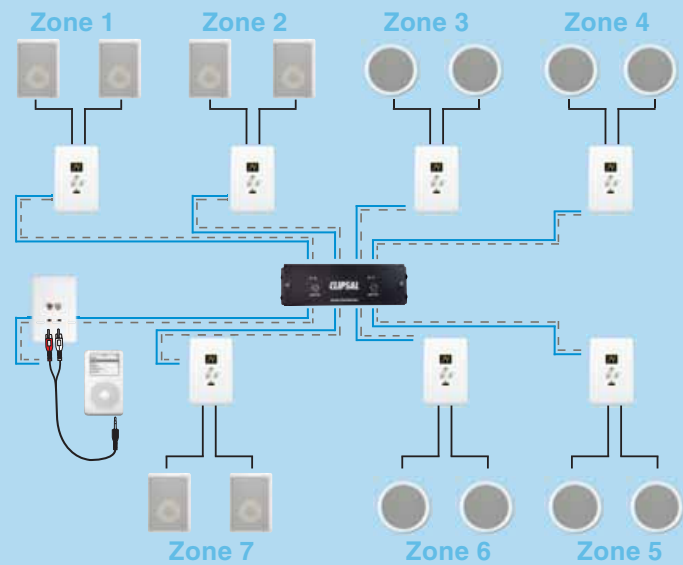

Seven Zones 'Star Wired' with 3105ADJB, with Local Inputs

Up to seven zones can be 'star wired' with a Local Stereo Input Module at each zone from the Audio Distribution Junction Box.

Each zone can be operated independently ON, OFF and volume settings.

Seven Zones can listen to the main music source or can listen to the local music source.

Additional zones can be added by connecting one Audio Distribution Junction Box to another.

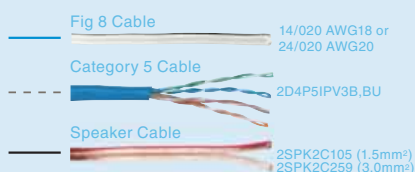
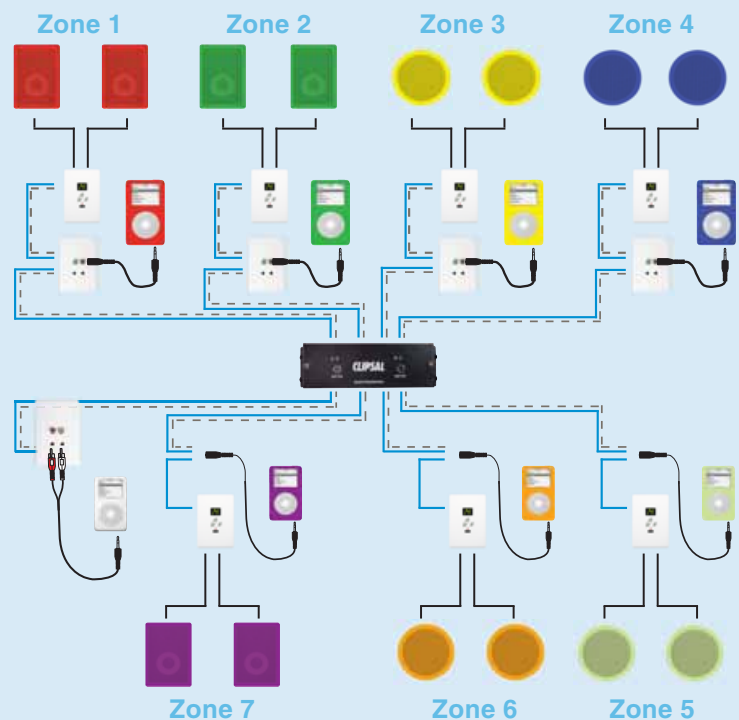

Four Zones 'Loop Wired'

Many wiring configurations can be adapted to the Clipsal Audio Solutions System and this makes the Clipsal Audio Solutions System the most flexible hard-wired solution on the market.

An example of this is having two or more zones connected to a local stereo input source.

This is a common installation issue with two audio zones close together such as an outdoor entertaining area and the main entertaining area connected by a sliding door.

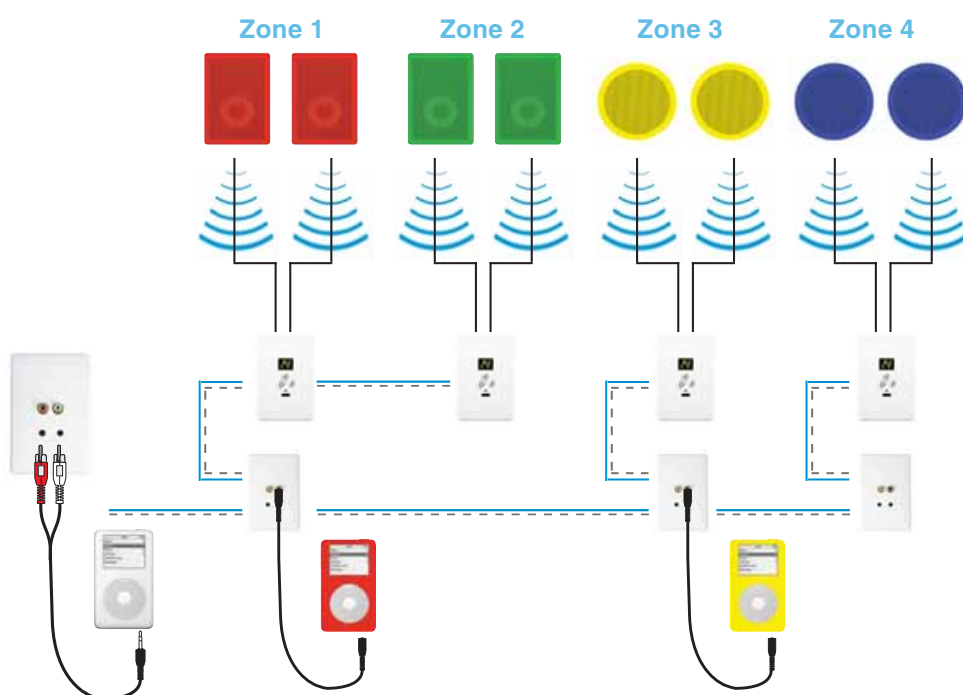

Product of Clipsal Australia Pty Ltd

A member of the Schneider Electric Group

Head Office

12 Park Terrace, Bowden
South Australia 5007
Telephone (08) 8269 0511
Facsimile (08) 8340 1724
Internet clipsal.com
E-Mail plugin@clipsal.com.au

National Customer Service Enquiries:
1300 2025 25

National Customer Service Facsimile:
1300 2025 56

International Enquiries

International Sales and Marketing

Telephone + 61 8 8269 0587
Facsimile + 61 8 8340 7350
E-Mail export@clipsal.com.au

New Zealand

Clipsal Industries (NZ) Ltd

Telephone (09) 576 3403
Facsimile (09) 576 1015
E-Mail headoffice@clipsal.co.nz

Customer Service

Free Fax (0508) 250 305
Auckland/Mobile Phone (09) 572 0014
Free Phone (0508) CLIPSAL
2547725

You can find this brochure and many others online in PDF format at:

clipsal.com

Follow the links off the home page or access the following page directly:
clipsal.com/wat_lib_pdf.cfm

clipsal.com

Clipsal Australia Pty Ltd reserves the right to change specifications, modify designs and discontinue items without incurring obligation and whilst every effort is made to ensure that descriptions, specifications and other information in this catalogue are correct, no warranty is given in respect thereof and the company shall not be liable for any error therein.

© Clipsal Australia Pty Ltd.

This material is copyright under Australian and international laws. Except as permitted under the relevant law, no part of this work may be reproduced by any process without prior written permission of and acknowledgement to Clipsal Australia Pty Ltd.